

# How to update firmware of your optical device

## STEP 1.

Connect your optical device to the Stream Vision application. Then turn the device off.

## STEP 2.

Activate mobile Internet or Wi-Fi in your mobile device. Launch the application.  
Please note: you may receive update notifications (if any available on the server) when your mobile device is online. You need at least one previous connection to the application to be able to receive updates.

## STEP 3.

Open **“My Devices”** in Stream Vision.  
Select the desired optical device (if several devices were connected).



## STEP 4.

Press the **“Check for update”** button. Download an update.  
The update downloads to the internal memory of your mobile device (or application) and will be kept there until you connect your optical device.



Important: when checking for update, make sure that your mobile device has Internet connection and the optical device is not connected to mobile device.

## STEP 5.

Connect your optical device and open **“My Devices”** in Stream Vision.  
In a pop-up box you have two options: to install update immediately or to do it later.

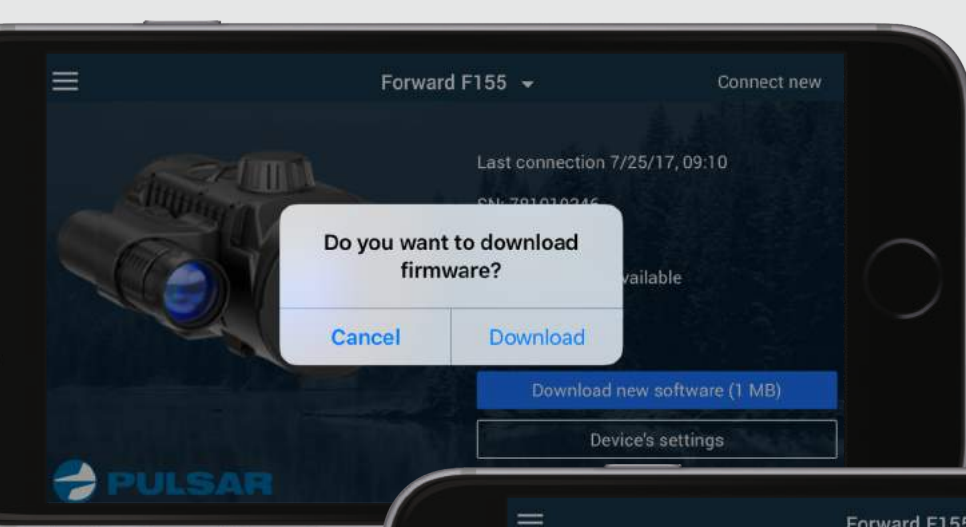

Please note: it's OK to cancel firmware download and keep using your device.

Press **“OK”** to confirm once download is completed.

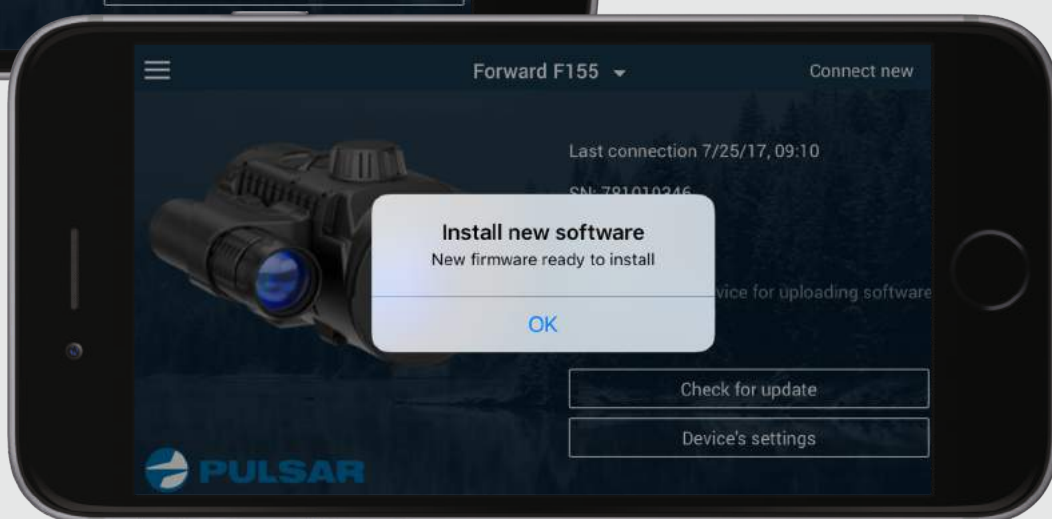

## STEP 6.

Press **“Install now”**. The application starts firmware transfer to your optical device.

Please make sure that your optical device is properly charged. If the device turns off during firmware transfer, you will need to re-connect to the application and install again.

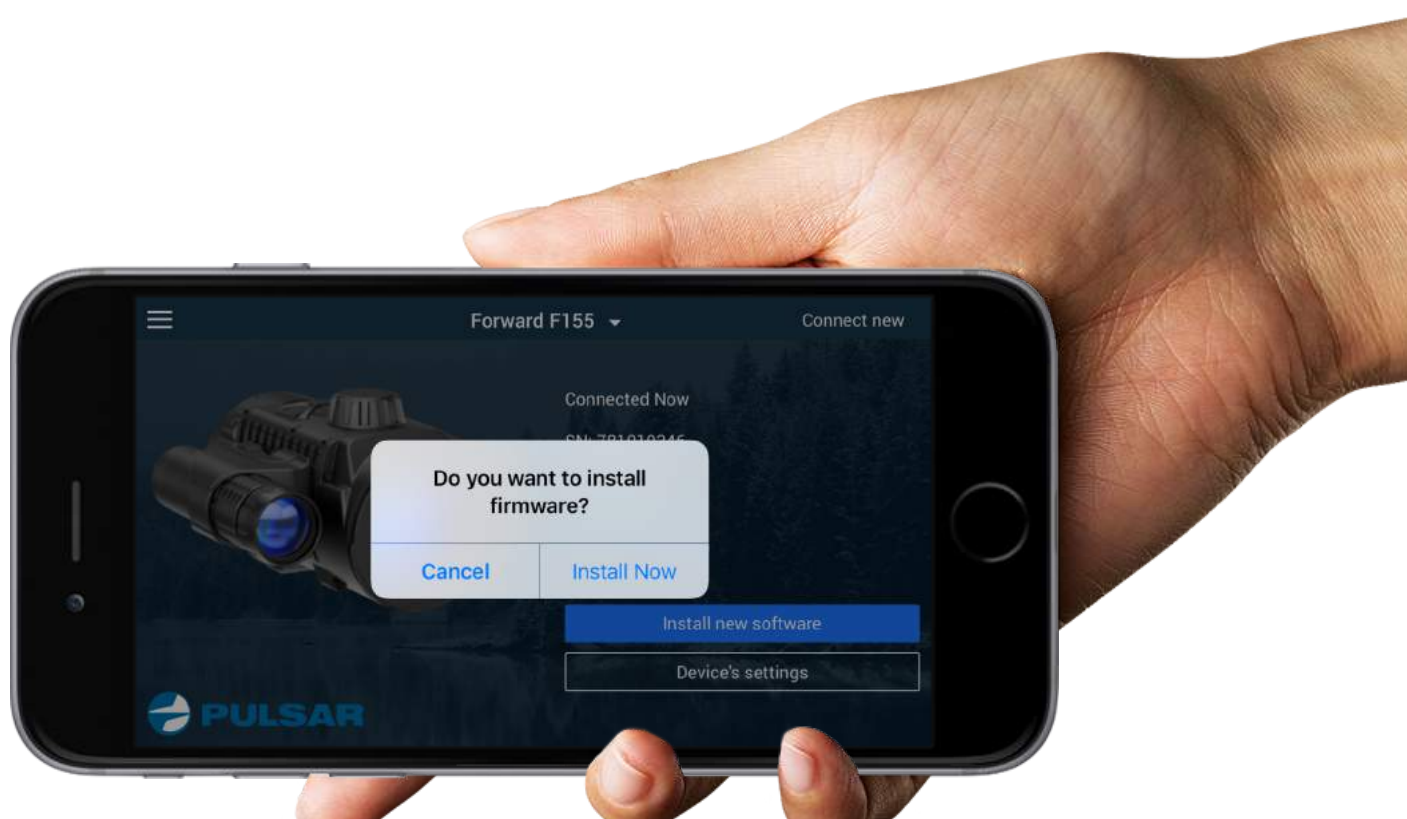

Once update installation is completed, the optical device turns off and the application receives update status notification.

